

ROSIN SMYTH

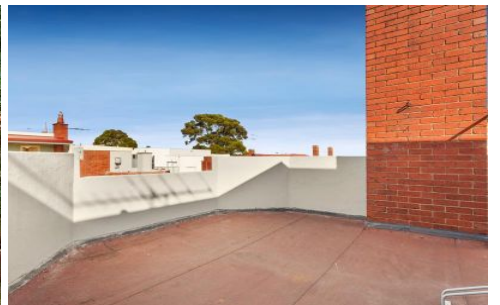

4/100 CURZON Street NORTH MELBOURNE VIC

2 1 1

TWO PERIOD TOWN RESIDENCES ARE TO BE OFFERED ON AN INDIVIDUAL BASIS.

OLD STYLE ORIGINAL ARCHITECTURE BLENDS WITH MODERN AMENITIES PROVIDING A UNIQUE APPEAL WITH SPACIOUS ACCOMADATION OVER THREE LEVELS.

TOP FLOOR OPEN OUTDOOR AREA OFFERS A PRIVATE AND EXCLUSIVE ENTERTAINING VENUE WITH STUNNING VIEWS OVER NORTH MELBOURNE AND THE CITY SKYLINE.

EXCELLENT FLOORPLAN COMPRISES:ENTRY FOYER,LARGE LIVING ROOM,KITCHEN/DINING,TWO SPACIOUS BEDROOMS(BUILT IN ROBES),CENTRAL BATHROOM AND SEPARATE LAUNDRY.

FEATURES INCLUDE:HYDRONIC HEATING,HIGH CIELINGS,AND EXPOSED BRICK WALLS .

CAR PARK ON TITLE LOCATED AT REAR OF

View : <https://www.rosinsmyth.com.au/6197866>



Martin Smyth
9695 5999

4/100 CURZON STREET, NORTH MELBOURNE

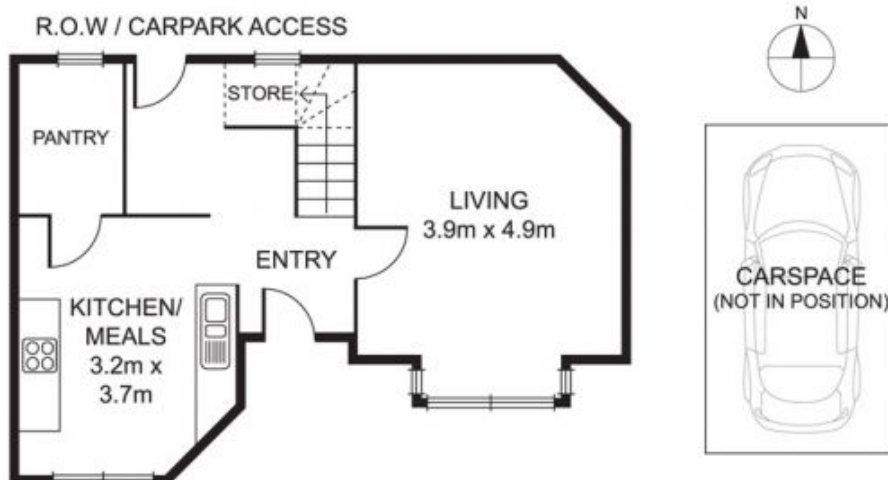
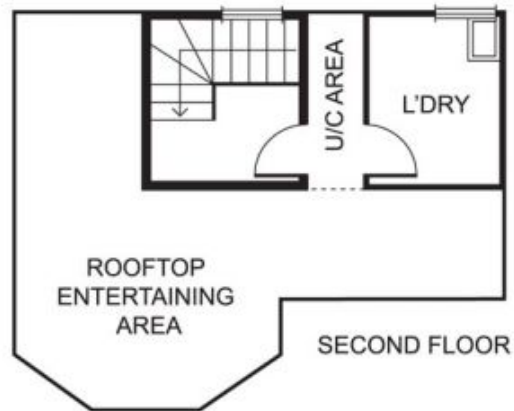

5/100 CURZON STREET, NORTH MELBOURNE

